

# Sagiv's Catalogue

High quality forged brass products for controlling  
Water, Gas, Fluids & air, HVAC and Solar applications.

[www.sagiv.com](http://www.sagiv.com)

  
**Partnering for Flow Control**

# White Line

A line of products designed for Flow Control Systems. The White Line valves include lead washing process. The Green Line includes a range of ball valves, angular valves, sanitary valves, garden valves, 3-way control valves, two-way & three-way actuators and more - all are used for flow control system containing water, air pressure, oil, fuel, diesel, etc.

The valves mechanism is based on Sagiv's high quality ball mechanism.

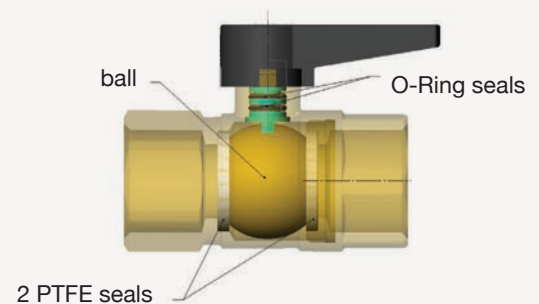

#### SPECIFICATIONS:

- Main body Material - Standard Brass CW617N (Optional DZR Brass)
- Ball Gaskets Material - P.T.F.E
- Working Pressure - up to 28 ATM (400psi)
- Working Temperature Range -5°C - +100°C

#### OPTIONS:

- Pipe Sizes - 1/2" up to 2"
- Material - Dezincification resistant brass (DZR)
- Led Free - Led Free process is available
- Threads - Male, Female, NPT, BSP
- Plating - Nickel, Nickel-Chrome
- Handle Size - Various handle size and shapes

In addition Sagiv provides custom-made solutions that can meet various customers' specific requirements.

#### STANDARDS:

The Green Line products are manufactured according to the Israeli standard no. 1144. Other international standards are available.

## SA 200 Ball Valve

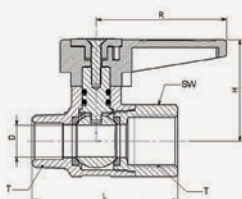

## FEATURES:

- Large bore ball valve with BSP Male to Female thread
- Temperature range: -5°C - +100°C
- Work pressure: Up to 28 Bar. Sagiv valves are adapted for vacuum environments
- P.T.F.E. seals that ensure a long life performance

## OPTIONS:

- Long handle • NPT thread • Nickel or Nickel-Chrome plating

CAT. NO. BSP	CAT. NO. NPT	T Thread	D Dia mm	H mm	L BSP mm	L NPT mm	Short Handle mm	Long Handle mm	SW HEX	Qty/Box Short Handle	Qty/Box Long Handle
1A2008000	1A2008100	1/2"	13.0	48.0	57.5	55.5	51.0	96.0	25.0	50	40
1A2012000	1A2012100	3/4"	17.0	52.0	70.0	69.5	51.0	96.0	32.0	40	30
1A2016000	1A2016100	1"	21.0	55.0	79.5	79.0	51.0	96.0	38.0	30	25
1A2L20000	-	1 1/4"	28.0	83.0	94.0	96.0	-	96.0	48.0	-	10
1A2L24000	1A2L24100	1 1/2"	32.0	83.0	99.0	93.0	-	147.0	56.0	-	6
1A2L32000	1A2L32100	2"	40.0	86.0	111.0	107.5	-	147.0	66.0	-	6
1A2016002	-	1" x 3/4"	21.0	55.0	79.5	-	51.0	96.0	38.0	30	25

## SN 200 Ball Valve

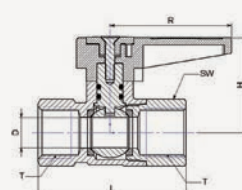

## FEATURES:

- Large bore ball valve with BSP Female to Female thread
- Temperature range: -5°C - +100°C
- Work pressure: Up to 28 Bar. Sagiv valves are adapted for vacuum environments
- P.T.F.E. seals that ensure a long life performance

## OPTIONS:

- Long handle • NPT thread • Nickel or Nickel-Chrome plating

CAT. NO. BSP	CAT. NO. NPT	T Thread	D Dia mm	H mm	L BSP mm	L NPT mm	Short Handle mm	Long Handle mm	SW HEX	Qty/Box Short Handle	Qty/Box Long Handle
1N2008000	1N2008100	1/2"	13.0	48.0	62.5	60.0	51.0	96.0	25.0	50	40
1N2012000	1N2012100	3/4"	17.0	52.0	72.5	69.0	51.0	96.0	32.0	40	30
1N2016000	1N2016100	1"	21.0	55.0	84.0	83.0	51.0	96.0	38.0	25	20
1N2L20000	1N2L20100	1 1/4"	28.0	83.0	94.0	96.0	-	96.0	48.0	-	10
1N2L24000	1N2L24100	1 1/2"	32.0	83.0	107.0	99.0	-	147.0	56.0	-	6
1N2L32000	1N2L32100	2"	40.0	86.0	122.0	121.0	-	147.0	66.0	-	4
1N2016002	-	1" x 3/4"	21.0	55.0	84.0	-	51.0	96.0	38.0	30	25

# Green Line

A line of products designed for Flow Control Systems. The Green Line includes a range of ball valves, angular valves, sanitary valves, garden valves, 3-way control valves, two-way & three-way actuators and more - all are used for flow control system containing water, air pressure, oil, fuel, diesel, etc.

The valves mechanism is based on Sagiv's high quality ball mechanism.

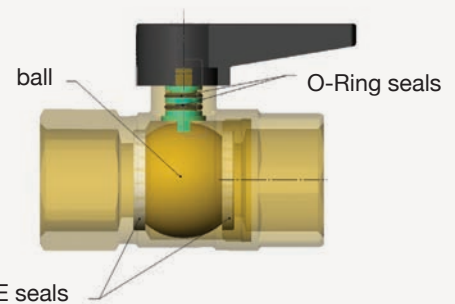

## SPECIFICATIONS:

- Main body Material - Standard Brass CW617N (Optional DZR Brass)
- Ball Gaskets Material - P.T.F.E
- Working Pressure - up to 28 ATM (400psi)
- Working Temperature Range -5°C - +100°C

## OPTIONS:

- Pipe Sizes - 1/8" up to 3/8"
- Material - Dezincification resistant brass (DZR)
- Led Free - Led Free process is available
- Threads - Male, Female, NPT, BSP
- Plating - Nickel, Nickel-Chrome
- Handle Size - Various handle size and shapes

In addition Sagiv provides custom-made solutions that can meet various customers' specific requirements.

## STANDARDS:

The Green Line products are manufactured according to the Israeli standard no. 1144. Other international standards are available.

## SA 200 Ball Valve

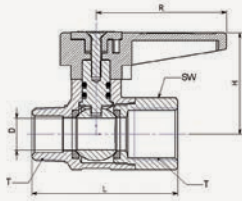

**FEATURES:**

- Large bore ball valve with BSP Male to Female thread
- Temperature range: -5°C - +100°C
- Work pressure: Up to 28 Bar. Sagiv valves are adapted for vacuum environments
- P.T.F.E. seals that ensure a long life performance

**OPTIONS:**

- Long handle • NPT thread • Nickel or Nickel-Chrome plating

CAT. NO. BSP	CAT. NO. NPT	T Thread	D Dia mm	H mm	L BSP mm	L NPT mm	Short Handle mm	Long Handle mm	SW HEX	Qty/Box Short Handle	Qty/Box Long Handle
1A1002000	1A1002100	1/8"	5.0	26.9	36.0	38.0	36.5	66.5	21.0	50	-
1A1004000	1A1004100	1/4"	8.0	26.9	41.5	46.5	36.5	66.5	21.0	50	-
1A1006000	1A1006100	3/8"	8.0	26.9	51.0	53.0	36.5	66.5	21.0	50	-

## SN 200 Ball Valve

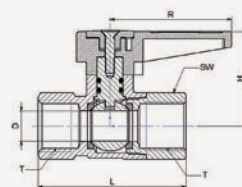

**FEATURES:**

- Large bore ball valve with BSP Female to Female thread
- Temperature range: -5°C - +100°C
- Work pressure: Up to 28 Bar. Sagiv valves are adapted for vacuum environments
- P.T.F.E. seals that ensure a long life performance

**OPTIONS:**

- Long handle • NPT thread • Nickel or Nickel-Chrome plating

CAT. NO. BSP	CAT. NO. NPT	T Thread	D Dia mm	H mm	L BSP mm	L NPT mm	Short Handle mm	Long Handle mm	SW HEX	Qty/Box Short Handle	Qty/Box Long Handle
1N1002000	1N1002100	1/8"	5.0	26.9	36.0	36.0	36.5	66.5	21.0	50	-
1N1004000	1N1004100	1/4"	8.0	26.9	41.5	46.5	36.5	66.5	21.0	50	-
1N1006000	1N1006100	3/8"	8.0	26.9	49.0	49.0	36.5	66.5	21.0	50	-

## Water Heater Valve



- Size: 1/2" x 1/2" or 3/4" Record thread
- **Blue** for cold water
- **Red** for hot water

## Garden Bibcock Ball Valve

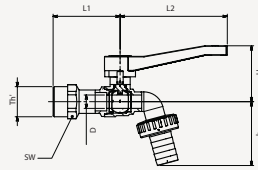

- Male thread connection to a flexible hose
- Teflon seals
- Work pressure: Up to 16 Bar

CAT. NO.	Size	D mm	H mm	L1 mm	L2 mm	Qty/Box
18BC08000	1/2"	9.0	36.5	52.7	66.5	80
18BC12000	3/4"	12.0	50.5	60.0	96.5	40

## Angle Valve

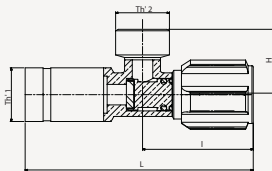

- Built-in teflon seal in the thread
- Increased water flow

CAT. NO.	Size	H mm	L mm	Qty/Box
18NL08006	1/2"x3/8"	25.5	89.5	120
18NL08008	1/2"x1/2"	25.5	89.5	120

## Combined Angle Valve

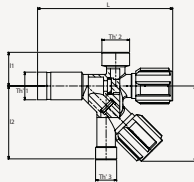

- Built-in teflon seal in the thread
- Increased water flow

CAT. NO.	Size	H mm	L mm	Qty/Box
18AC08006	1/2"x3/8"	25.5	89.5	80

## Washing Machine Valve



CAT. NO.	Size	Qty/Box
-	1/2"x3/4"	-

## Lavatory Diverter Ball Valve

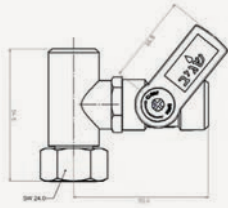

- T ball valve split connection between the domestic pipe system and lavatory water tank.

CAT. NO.	Size	L mm	L1 mm	L2 mm	Qty/Box
1HSL0T000	1/2"	35	11.8	12	20

## T Diverter Bar Valve



- T ball valve split connection between the domestic pipe system and the domestic water bar.

CAT. NO.	Size	Qty/Box
1BRT06006	3/8" x 3/8" x 6 mm	50
1BRT08006	1/2" x 1/2" x 6 mm	50

## Bar Valve



- Ball valve to connect a domestic water bar to the domestic pipe system.

CAT. NO.	Size	Qty/Box
1BAR00006	1/2" x 6 mm	50
1TNA00000	1/2" x 8 mm	50

## Dish Washer Diverter Valve



- T ball valve used to connect a dish washer pipe to the domestic pipe system.

CAT. NO.	Size	Qty/Box
1BRT06000	3/8" x 3/8" x 3/4"	50
1BRT08000	1/2" x 1/2" x 3/4"	50

# Yellow Line

A line of products designed for LPG & Natural Gas systems.

The Yellow Line includes a range of Gas ball valves, quick connection valves, Angular valves, T valves and manifolds.

The valves mechanism is based on Sagiv's high quality ball mechanism (see drawing).

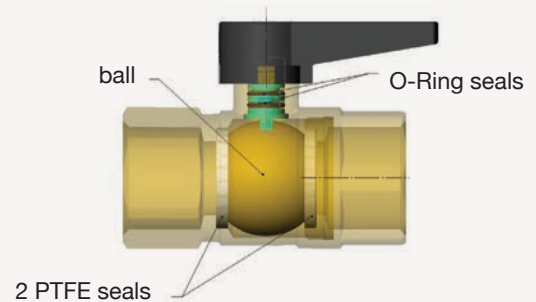

## SPECIFICATIONS:

- Main body Material – Standard Brass CW617N
- Ball Gaskets Material – P.T.F.E
- Working Pressure – up to 5 BAR

## OPTIONS:

- Pipe Sizes - 1/4" up to 2"
- Threads - Male, Female, NPT, BSP
- Connection Types - Flare, Compression Join (Olive), • Rubber pipe
- Plating - Nickel, Nickel-Chrome
- Brackets - Can be added to any ball valve of up to 3/4" in diameter.
- When you order please add "C" to the product name.

For example:

SGA – Gas valve Female Male thread

SGAC - Gas valve Female Male thread + Bracket

In addition Sagiv provides custom-made solutions that can meet various customers' specific requirements.

## STANDARDS:

The Yellow Line products are manufactured according to the Israeli standard no. 1607 which is identical to the European standard EN-331. Other international standards are available.



## Mini Gas Ball Valve Model 1



- One side - connection to copper pipe by compression fitting or flare
- Other side - connection to rubber tube
- Comes with a bracket
- Work Pressure: up to 5 Bar

Cat. No.	D Diameter	Type	Qty/Box
1G1F04001	5.5 mm	Rubber Tube - Flare 1/4"	50
1G1F05001	5.5 mm	Rubber Tube - Flare 5/16"	50
1G1F06001	5.5 mm	Rubber Tube - Flare 3/8"	50
1G1Z04001	5.5 mm	Rubber Tube - Compression fitting 1/4"	50
1G1Z05001	5.5 mm	Rubber Tube - Compression fitting 5/16"	50
1G1Z06001	5.5 mm	Rubber Tube - Compression fitting 3/8"	50
1FP809011	5.5 mm	Rubber Tube - Flare 1/2"	40

## Mini Angular Gas Ball Valve



- One side - connection to copper pipe by flare or compression fitting
- Other side - connection to rubber tube
- Can be fitted with right or left outlet to rubber tube as required
- Comes with a bracket
- Work pressure: up to 5 Bar

Cat. No.	D Diameter	Type	Qty/Box
1GRF040Z0	5.5 mm	Flare 1/4" - Right	50
1GLF040Z0	5.5 mm	Flare 1/4" - Left	50
1GRF050Z0	5.5 mm	Flare 5/16" - Right	50
1GLF050Z0	5.5 mm	Flare 5/16" - Left	50
1GRZ050Z0	5.5 mm	Compression fitting 5/16" - Right	50
1GLZ050Z0	5.5 mm	Compression fitting 5/16" - Left	50
1GRF060Z0	5.5 mm	Flare 3/8" - Right	50
1GLF060Z0	5.5 mm	Flare 3/8" - Left	50
1GRZ060Z0	5.5 mm	Compression fitting 3/8" - Right	50
1GLZ060Z0	5.5 mm	Compression fitting 3/8" - Left	50

## Mini Quick Connection Gas Ball Valve



- One side - connection to copper pipe by flare
- Other side - connection to rubber tube
- Comes with a bracket
- Work pressure: Up to 0.3 Bar
- Approved for the American CSA standard
- Checked by ANSIZ 21,41 - 1998
- Approved for the new Israeli standard 1607

Cat. No.	D Diameter	Type	Qty/Box
1QAF05000	5.5 mm	Flare 5/16" - Tube - quick connection	25
1QAF06000	5.5 mm	Flare 3/8" - Tube - quick connection	25

## Mini Gas Ball Valve Model 2



- One side - connection to copper pipe
- Other side - connection to copper pipe
- Connection by flare or compression fitting
- Comes with a bracket
- Work pressure: Up to 5 Bar

Cat. No.	D Diameter	Type	Qty/Box
1G2F05001	5.5 mm	Flare 5/16" - Flare 5/16"	50
1G2F06001	5.5 mm	Flare 3/8" - Flare 3/8"	50
1G2Z05001	5.5 mm	Compression fitting 5/16" - Compression fitting 5/16"	50
1G2Z06001	5.5 mm	Compression fitting 3/8" - Compression fitting 3/8"	50
1FF809011	9.8 mm	Flare 1/2" - Flare 1/2"	30

## T Gas Ball Valve



- Direct one-way flow and a cut-off valve to an extra gas point
- Connection by flare
- Work pressure: Up to 5 Bar

Cat. No.	D Diameter	Type	Qty/Box
1G0001000	7.0 mm	Flare 3/8"-Flare 3/8"-Flare 3/8"	50
1G0001002	7.6 mm	Flare 1/2"-Flare 3/8"-Flare 1/2"	50
1G0001001	9.0 mm	Flare 1/2"-Flare 1/2"-Flare 1/2"	50
1G0001003	6.0 mm	Flare 1/2"-Flare 1/4"-Flare 1/2"	50
1G0110102	9.5 mm	Flare 5/8"-Flare 5/8"-Flare 1/2"	40
1G0110100	9.5 mm	Flare 5/8"-Flare 5/8"-Flare 5/8"	50

## 2-3-4 Gas Ball Valves Manifolds



- A combined valve system, used for distribution of the regulated gas to multiple meters and/or consumer points
- All manifolds are easy to assemble with right or left outlets
- Yellow line manifolds allow maximum gas capacity
- Work pressure: Up to 5 Bar

Cat. No.	D Diameter	Type	Qty/Box
1G0206100	6.0 mm	3/8" Manifold - 2 Outlets	15
1G0306100	6.0 mm	3/8" Manifold - 3 Outlets	10
1G0406100	6.0 mm	3/8" Manifold - 4 Outlets	10
1G0209100	9.5 mm	1/2" Manifold - 2 Outlets	15
1G0308100	9.5 mm	1/2" Manifold - 3 Outlets	10
1G0409100	9.5 mm	1/2" Manifold - 4 Outlets	10
1G0210100	9.5 mm	1/2"x5/8" Manifold - 2 Outlets	15
1G0410100	9.5 mm	1/2"x5/8" Manifold - 4 Outlets	10

## SGN Gas Ball Valve



- One side - Female NTP thread
- Other side - Female NTP thread
- Work pressure: Up to 5 Bar

Cat. No.	D Diameter	Type	Qty/Box
1N1002108	5 mm	Female 1/8" - Female 1/8"	50
1N1004108	8 mm	Female 1/4" - Female 1/4"	50
1N1006108	8 mm	Female 3/8" - Female 3/8"	50
1N2008108	13 mm	Female 1/2" - Female 1/2"	50
1N2012108	17 mm	Female 3/4" - Female 3/4"	40
1N2016108	21 mm	Female 1" - Female 1"	25
1N2L20108	28 mm	Female 1.1/4" - Female 1.1/4"	6
1N2L24108	32 mm	Female 1.1/2" - Female 1.1/2"	6
1N2L32108	40 mm	Female 2" - Female 2"	4

## SGA Gas Ball Valve



- One side - Male NPT thread
- Other side - Female NPT thread
- Work pressure: Up to 5 Bar

Cat. No.	D Diameter	Type	Qty/Box
1A1002108	5 mm	Male 1/8" - Female 1/8"	50
1A1004108	8 mm	Male 1/4" - Female 1/4"	50
1A1006108	8 mm	Male 3/8" - Female 3/8"	50
1A2008108	13 mm	Male 1/2" - Female 1/2"	50
1A2012108	17 mm	Male 3/4" - Female 3/4"	40
1A2016108	21 mm	Male 1" - Female 1"	25

## SGP Gas Ball Valve



- One side - connection to rubber tube
- Other side - NPT thread:  
Male NPT thread (SGAP)  
Female NPT thread (SGNP)
- Work pressure: up to 5 Bar

SGNPC - Valve + Wall Bracket

SGAPC - Valve + Wall Bracket

Cat. No.	D Diameter	Type	Qty/Box	Cat. No.	D Diameter	Type	Qty/Box
1N1P04100	5.5 mm	Female 1/4" - Tube	50	1A1P04100	5.5 mm	Male 1/4" - Tube	50
1N2P08108	5.5 mm	Female 1/2" - Tube	50	1A2P08108	5.5 mm	Male 1/2" - Tube	50

## SGFC Gas Ball Valve



- One side - Female NPT thread
- Other side - Flare connecton to copper pipe
- Comes with nickel plating and a bracket
- Work pressure: Up to 5 Bar

Cat. No.	D Diameter	Type	Qty/Box
1NF609101	7.0 mm	Female 1/2" - Flare 3/8"	50
1NF809111	9.8 mm	Female 1/2" - Flare 1/2"	30

## SGC Gas Ball Valve



- NPT thread on both sides  
Male to Female NPT thread (SGAC)  
Female to Female NTP thread (SGNC)
- Comes with a bracket
- Work pressure: up to 5 Bar

SGAC				SGNC			
Cat. No.	D Diameter	Type	Qty/Box	Cat. No.	D Diameter	Type	Qty/Box
1A1004109	8 mm	Male 1/4" - Female 1/4"	50	1N1004109	8 mm	Female 1/4" - Female 1/4"	50
1A2008101	13 mm	Male 1/2" - Female 1/2"	40	1N2008101	13 mm	Female 1/2" - Female 1/2"	40
				1N2012101	17 mm	Female 3/4" - Female 3/4"	30

## SGF Gas Ball Valve



- One side: Flare connection to copper pipe
- Other side:  
Male NPT thread (SGAF)  
Female NPT thread (SGNF)
- Work pressure: up to 5 Bar

SGAF				SGNF			
Cat. No.	D Diameter	Type	Qty/Box	Cat. No.	D Diameter	Type	Qty/Box
1F3004100	7.0 mm	Male 1/4" - Flare 3/8"	50	1NF609100	7.0 mm	Female 1/2" - Flare 3/8"	50
1F4004100	7.0 mm	Male 1/4" - Flare 1/2"	50	1NF809100	7.0 mm	Female 1/2" - Flare 1/2"	40
1AF609100	7.0 mm	Male 1/2" - Flare 3/8"	50				
1AF809100	9.8 mm	Male 1/2" - Flare 1/2"	40				

## Dielectric Connectors For Gas Valves



- Designed to protect accumulating tanks against corrosion
- Manufactured with P.O.L male or female thread
- Work Pressure: Up to 25 Bar

Cat. No.	D Diameter	Type	Qty/Box
1GMH0810P	8 mm	N.P.T 1/2" thread	50
1GPOL0000	8 mm	P.O.L 511" thread	30

## Flare Nuts For Gas Valves



- A range of flare nuts for use with copper pipes

Cat. No.	Type	Qty/Box
C40F04001	Flare Nuts 1/4"	500
C40F05001	Flare Nuts 5/16"	500
C40F08001	Flare Nuts 1/2"	500
C40F08003	Flare Nuts 5/16" x 3/8"	-
C40F08001	Flare Nuts 1/2"	500

## Gas Safety Ball Valve



### FEATURES:

Manually operated gas safety valve assembly with lockable handle, designed to prevent accidental opening of the gas line by children.

Thermal protection fuse that automatically shuts-off the gas flow when the valve is exposed to high temperature, e.g. in case of fire. Once activated, the thermal fuse cannot be open again.

Excess flow valve assembly with automatic reset function, that provides quick shut-off of the gas flow in the case of accidental increase in gas flow rate e.g. when a gas pipe is disconnected or broken.

Once closed, the excess flow valve remains closed until the pipe system is repaired and pressure on both sides of the valve is equalized.

### MATERIALS:

- Body - Brass with Nickel Plating
- Ball - Brass with Chrome Plating
- Thermal assembly valve - Brass
- Fusible material - Bismuth 96
- Excess flow valve - NBR Rubber
- Thermal assembly spring - Stainless Steel
- Excess flow assembly spring - Stainless Steel
- Ball valve handle - Reinforced Nylon
- Gaskets - Teflon and NBR Rubber

### TECHNICAL DATA:

- Inlet - 3/8" O.D. Copper Pipe Flare
- Outlet - 3/8" I.D. Rubber Tube
- Temperature of thermal fuse activation - 96°C
- Closing flow rate - 0.9 kg LPG/h
- Maximal flow rate after closing (bypass flow) - 5 l/h
- Operating pressure - 30 mbar
- Maximal pressure drop - 5 mbar

CAT. NO.	Size	Size	Qty/Box
1GS006000	3/8"	Straight	40
1GSR06000	3/8"	Right Angle	25
1GSL06000	3/8"	Left Angle	25

# Blue Line

A line of products designed for HVAC Systems  
The Blue Line includes a range of ball valves and zone valves. The ball valves range characterizes by an elongated handle which makes them perfect for HVAC installation.

The valves mechanism is based on Sagiv's high quality ball mechanism.

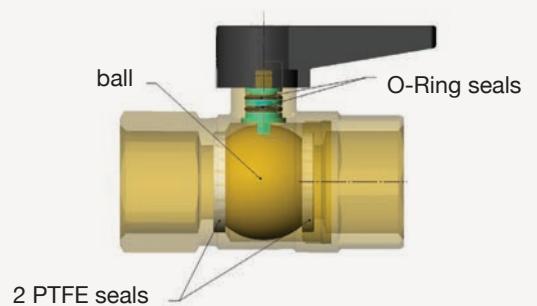

## SPECIFICATIONS:

Main body Material - Standard Brass CW617N

Ball Gaskets Material - P.T.F.E

Working Pressure - up to 28 ATM (400psi)

Working Temperature Range -  $-5^{\circ}\text{C}$  -  $+100^{\circ}\text{C}$

## OPTIONS:

Pipe Sizes - 1/2" up to 2"

Threads - Male, Female, NPT, BSP, Flare

Plating - Nickel, Nickel-Chrome

Handle Size - Various handle size and shapes

In addition Sagiv provides custom-made solutions that can meet various customers' specific requirements.

## STANDARDS:

The Blue Line products are manufactured according to the Israeli standard no. 1144.

Other international standards are available.

## SHN 200 Ball Valve

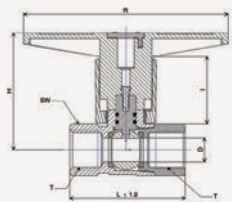

- Elongated handle ball valve with BSP Female to Female thread
- P.T.F.E. seals
- Temperature range: -5° - +100°C
- Work pressure: Up to 28 Bar (400 psi)
- NPT thread optional

CAT. NO. BSP	T Thread	D Dia mm	DN mm	H mm	I mm	L mm	R mm	SW HEX	Qty/Box
1N2008007	1/2"	13.0	15.0	66.5	35.5	62.5	110.0	25.0	30
1N2012007	3/4"	17.0	20.0	66.0	35.5	72.5	110.0	32.0	30
1N2016007	1"	21.0	25.0	69.0	35.5	84.0	110.0	38.0	20
1N2020007	1 1/4"	28.0	30.0	74.0	35.5	96.0	110.0	48.0	10

## SHNL 200 Ball Valve

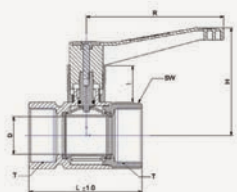

- Elongated handle ball valve with BSP Female to Female thread
- Longer handle for ease of operation
- P.T.F.E. seals
- Temperature range: -5° - +100°C
- Work pressure: Up to 28 Bar (400 psi)
- NPT thread optional

CAT. NO. BSP	T Thread	D Dia mm	DN mm	H mm	I mm	L mm	R mm	SW HEX	Qty/Box
1N2L24007	1 1/2"	32.0	40.0	108	39.0	107.0	147	56.0	6
1N2L32007	2"	40.0	50.0	114	39.0	121.0	147	66.0	4

## SHA 200 Ball Valve

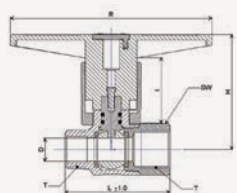

- Elongated handle ball valve with BSP Male to Female thread
- P.T.F.E. seals
- Temperature range: -5° - +100°C
- Work pressure: Up to 28 Bar (400 psi)
- NPT thread optional

CAT. NO. BSP	T Thread	D Dia mm	DN mm	H mm	I mm	L mm	R mm	SW HEX	Qty/Box
1A2008007	1/2"	13.0	15.0	62.0	35.5	57.5	110.0	25.0	30
1A2012007	3/4"	17.0	20.0	66.0	35.5	70.0	110.0	32.0	30
1A2016007	1"	21.0	25.0	69.0	35.5	79.5	110.0	38.0	20
1A2020007	1 1/4"	27.0	30.0	74.0	35.5	94.0	110.0	48.0	10

## SHAL 200 Ball Valve

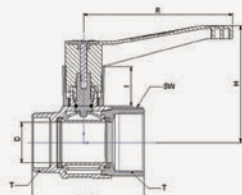

- Elongated handle ball valve with BSP Male to Female thread
- Longer handle for ease of operation
- P.T.F.E. seals
- Temperature range: -5° - +100°C
- Work pressure: Up to 28 Bar (400 psi)
- NPT thread optional

CAT. NO. BSP	T Thread	D Dia mm	DN mm	H mm	I mm	L mm	R mm	SW HEX	Qty/Box
1A2L24007	1 1/2"	32.0	40.0	108	39.0	99.0	147	56.0	6
1A2L32007	2"	40.0	50.0	114	39.0	110.0	147	66.0	4

## SHNF 200 Ball Valve

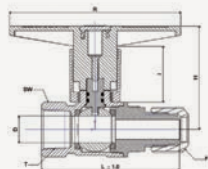

- Elongated handle ball valve with BSP Female thread to Flare connection
- P.T.F.E. seals
- Temperature range: -5° - +100°C
- Work pressure: Up to 28 Bar (400 psi)
- NPT thread optional

CAT. NO. BSP	T Thread	D Dia mm	DN mm	H mm	I mm	L mm	R mm	SW HEX	Qty/Box
1N2F08001	1/2" x F5/8"	13.0	15.0	66.0	35.5	85.6	110.0	25.0	30
1N2F12001	3/4" x F5/8"	17.0	20.0	66.0	35.5	87.6	110.0	32.0	25
1N2F12003	3/4" x F3/4"	17.0	20.0	66.0	35.5	87.6	110.0	32.0	25

## SHAF 200 Ball Valve

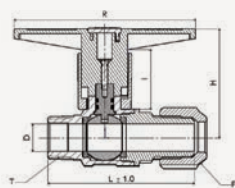

- Elongated handle ball valve with BSP Male thread to Flare connection
- P.T.F.E. seals
- Temperature range: -5° - +100°C
- Work pressure: Up to 28 Bar (400 psi)
- NPT thread optional

CAT. NO. BSP	T Thread	D Dia mm	DN mm	H mm	I mm	L mm	R mm	SW HEX	Qty/Box
1A2F08001	1/2" x F5/8"	13.0	15.0	66.0	35.5	85.5	110.0	26.0	30
1A2F12001	3/4" x F5/8"	17.0	20.0	66.0	35.5	85.5	110.0	28.0	25
1A2F12003	3/4" x F3/4"	17.0	20.0	66.0	35.5	85.5	110.0	28.0	25



## CLICK CONTROL Motorized Zone Valve

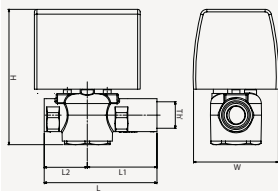

**ADVANTAGES:**

- Speedy open/close operation
- Easy installation
- Reliable
- Heavy duty

**APPLICATIONS:**

- Temperature control in heating/cooling systems
- Liquids release in high pressure systems
- Flow control in agricultural and industrial water systems
- Fuel systems to control burners
- Gas flow regulation
- Steam systems (low temperature), laundries, kitchens etc.

### 2-Way Click Control

CAT. NO.	Size	H mm	L mm	L1 mm	L2 mm	W mm	Qty/Box
18FC080T2	1/2"	106.8	89.0	55.0	34.0	67.0	10
18FCF0002	5/8"	106.8	89.0	55.0	34.0	67.0	10
18FC120T2	3/4"	104.0	87.0	43.5	43.5	67.0	10
18FM160T2	1"	127.0	105.0	48.0	48.0	67.0	10
18EN00000	Motor only	-	-	-	-	-	10

### 3-Way Click Control

CAT. NO. BSP	T Thread	D Dia mm	DN mm	H mm	l mm	L mm	R mm
18FC080T3	1/2"	106.8	89.0	55.0	34.0	67.0	10
18FCF0003	5/8"	106.8	89.0	55.0	34.0	67.0	10
18FC120T3	3/4"	104.0	87.0	43.5	43.5	67.0	10
18FM160T3	1"	136.0	95.0	48.0	48.0	67.0	10
18EN00000	Motor only	-	-	-	-	-	10

# Control & Safety

A line of high quality valves aimed at variable control and Safety functions.

All the valves are based on Sagiv's Ball Valve high quality mechanism.

## SMA Ball Valve

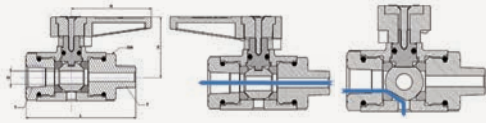

**FEATURES:**

- BSP Male to Female threaded ball valve with Air/Liquid release aperture
- Work pressure: Up to 25 Bar. Sagiv valves are adapted for vacuum environments • P.T.F.E. seals that ensure a long life performance

**OPTIONS:**

- NPT thread

**UTILIZATION:**

- At the inlet of pressure meters, the meter is readable when the valve is open and when the valve is closed the air or liquid is released and the meter remains without pressure

CAT. NO. BSP	CAT. NO. NPT	T THREAD	D Dia mm	H mm	L mm	R mm	SW HEX	Qty/Box
1MAH02000	1MAH02100	1/8"	4.0	27.3	55.6	36.5	20	50
1MAH04000	1MAH04100	1/4"	6.0	27.3	66.2	36.5	20	50
1MAH06000	1MAH06100	3/8"	6.0	27.3	61.2	36.5	20	50
1MAH08000	1MAH08100	1/2"	6.0	27.3	59.2	36.5	20	50

## SMN Ball Valve

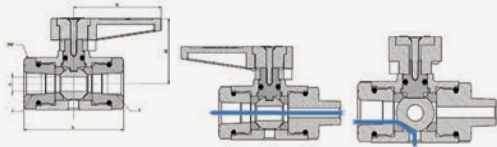

**FEATURES:**

- BSP Female to Female threaded ball valve with Air/Liquid release aperture
- Work pressure: Up to 25 Bar. Sagiv valves are adapted for vacuum environments • P.T.F.E. seals that ensure a long life performance

**OPTIONS:**

- NPT thread

**UTILIZATION:**

- At the inlet of pressure meters, the meter is readable when the valve is open and when the valve is closed the air or liquid is released and the meter remains without pressure

CAT. NO. BSP	CAT. NO. NPT	T THREAD	D Dia mm	H mm	L mm	R mm	SW HEX	Qty/Box
1MNH02000	1MNH02100	1/8"	4.0	27.3	41.2	36.5	20	50
1MNH04000	1MNH04100	1/4"	6.0	27.3	43.0	36.5	20	50
1MNH06000	1MNH06100	3/8"	6.0	27.3	58.0	36.5	20	50
1MNH08000	1MNH08100	1/2"	6.0	27.3	73.2	36.5	20	50

## SY - 3 Way Ball Valve

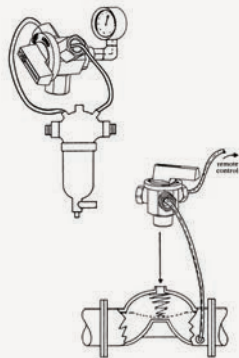

The SY three-way ball valves are the professional's choice for hydraulic flow control. The valves are constructed with a common port at the base of the valve body. Any of the three peripheral ports can be connected to the common port - the other ports are totally sealed. SY is designed for three hydraulic control positions: Open, Closed, and Automatic.

**SPECIFICATION:**

- Passage size: SY3: 3.2 mm (1/8"), SY6: 6.0 mm (1/4") • P.T.F.E. seals

- BSP or NPT threads • Ball valve principle

**ADVANTAGES:**

- Using SY, the hydraulic valve can be manually opened/closed in case of operational fault
- Only one moving part
- Easy to assemble
- Easy viewing of the operating position
- All valves are sealed when in a 'between port' position
- Special large bore valve for controlling extra-large hydraulic valves (SY6)
- High quality Teflon seals and Chrome-Nickel plated balls, resistant to all types of irrigation water

Cat. No. BSP	Cat. No. NPT	Model	Inlet	Open	Close	Remote	Qty/Box
1Y3A02000	1Y3A02100	SY-3	1/8" M	1/8" F	1/8" F	1/8" F	50
1Y3N02000	1Y3N02100	SY-3	1/8" F	1/8" F	1/8" F	1/8" F	50
1Y3A04000	1Y3A04100	SY-3	1/4" M	1/8" F	1/8" F	1/8" F	50
1Y3N04000	1Y3N04100	SY-3	1/4" F	1/8" F	1/8" F	1/8" F	50
1Y3N040A4	1Y3N041A4	SY-3	1/4" F	1/8" F	1/8" F	1/4" M	50
1Y3N040A2	1Y3N041A2	SY-3	1/4" F	1/8" M	1/8" F	1/8" F	50
1Y3N040A3	-	SY-3	1/4" F	1/8" F	1/8" M	1/8" M	50
1Y3A040A4	1Y3A041A4	SY-3	1/4" M	1/4" M	1/8" F	1/8" F	50
1Y6N04000	1Y6N04100	SY-6	1/4" F	1/4" F	1/4" F	1/4" F	25
1Y6A04000	1Y6A04100	SY-6	1/4" M	1/4" F	1/4" F	1/4" F	25

## Check Valve 3/4"

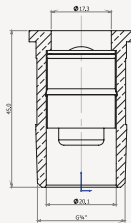

**FEATURES:**

- Built in non-return
- Work pressure: Up to 10 Bar
- Temperature range: Up to 90°C
- Very low head loss
- For installation in water metering systems, at the outlet of the meter
- Prevents backflow of water or air, reduces futile operation of the meter and therefore drastically cuts down water consumption over-charges
- Easy immediate installation without a need for changes in the water meters system

CAT. NO.	Size	Qty/Box
1MD000000	3/4"	100

## Motorized Ball Valve

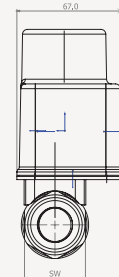
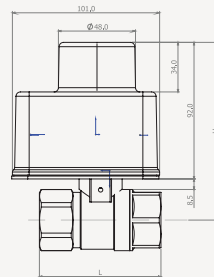

A new improved version of Sagiv's quality motorized ball valve and electric actuator, for control of slow regulation of liquids and different gases under pressure, suitable for industrial, agricultural and construction systems.

**CHARACTERISTICS:**

- Speedy three seconds open/close operation
- Power supply: 12V/24V AC/DC - preset in factory
- Waterproof
- Working temperatures:
- Working temp. 100°C
- Short term temp. 140°C
- 90° revolution between open and closed positions
- Optional auxiliary output to indicate fully opened valve position
- Single switch operation
- Configuration: Please select the desired valve diameter, electric voltage and current type.
- Valve sizes: 1/2", 3/4", 1"
- Power inlet options: 12V DC, 12V AC, 24V DC, 24V AC
- Normally Open (N.O.) / Normally Closed (N.C.)
- Optional LED indication for fully open valve position

**AVAILABLE MOTOR TYPES:**

CAT. NO.	Voltage	Current	Position	Indicator
1ENA00012	12V	AC	N/C	NO
1ENAO0012	12V	AC	N/O	NO
1END00012	12V	DC	N/C	NO
1ENDO0012	12V	DC	N/O	NO
1ENA00024	24V	AC	N/C	NO
1ENAO0024	24V	AC	N/O	NO
1END00024	24V	DC	N/C	NO
1ENDO0024	24V	DC	N/O	NO
1ENA0L024	24V	AC	N/C	YES
1END0L024	24V	DC	N/C	YES
1END0L024	24V	DC	N/O	YES

**APPLICATIONS OF THE MOTORIZED BALL VALVE:**

- Temperature control in heating/cooling systems.
- Liquids release in high pressure systems.
- Flow control in agricultural and industrial water systems.
- Fuel systems to control burners.
- Gas flow regulation.
- Steam systems (low temperature), laundries, kitchens etc...

**AVAILABLE VALVES TYPES:**

CAT. NO.	Size	H mm	L mm	SW HEX
1N2008013	1/2" F-F	114.5	62.5	25
1N2012013	3/4" F-F	118.0	72.5	32
1N2016013	1" F-F	121.5	84.0	38
1A2008013	1/2" M-F	114.5	57.5	25
1A2012013	3/4" M-F	118.0	70.0	32
1A2016013	1" M-F	121.5	79.5	38

**ADVANTAGES OF THE MOTORIZED BALL VALVE:**

- Speedy open/close operation
- Easy installation
- Reliable
- Heavy duty

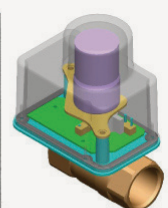
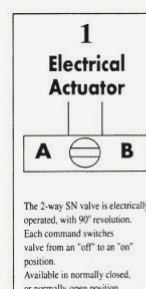

## ThermoGard TSO 45°C

Washable Thermostatic Mixing Valve (TMV)  
that allows for system sanitation

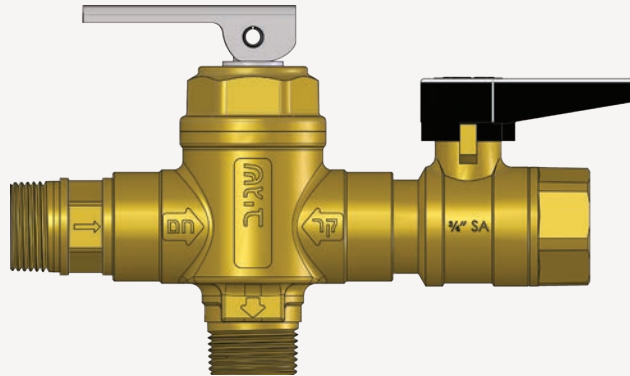

Special applications TMV aimed at locations such as nursing and sheltered accommodation. The TMV limited the hot water temperature to 45°C to prevent scalds and include a built-in mechanism that allows for system sanitation, in order to prevent bacterial infection (such as Legionella). The TMV is approved by the Israeli Ministry of Health.

Instructions for flushing the system and executing a shock treatment using a thermal shock.

The flushing of the system will be done in the frequency indicated in the local Standard and according to the requirements of the Ministry of Health.

1. Closing the ball valve at the cold water inlet
2. Opening the upper valve lever to vertical position
3. Flushing hot water at the required temperature for the duration required following the sanitation guidelines.
4. Lowering the upper valve lever and opening the ball valve back to working mode.
5. Checking that the temperature is back to 42°C-45°C.

## ThermoWise

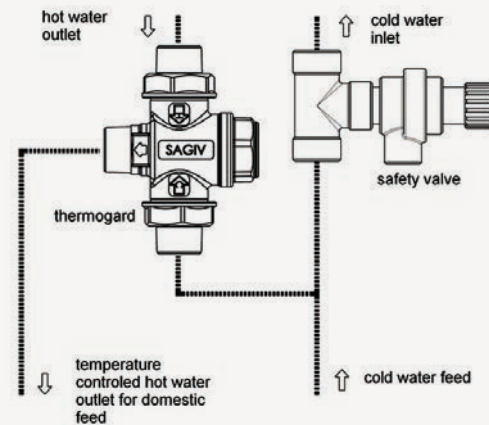

**Sagiv ThermoWise** is an innovative thermostatic diverting valve that maximizes the energy savings and minimizes the energy cost, in a combined water heating system, typically for a Solar system that is backed-up by a Gas water heater. When such a combined system is used Sagiv ThermoWise controls the Solar system hot water outlets as follow: When the temperature is hot enough (pre-defined) the flow is diverted to the home hot water piping system. However, when the temperature drops below the pre-defined temperature, the flow is diverted to the Gas heater.

In such automatic control, the Solar energy use is maximized and the Gas heater is only used when necessary.

**FEATURES:**

- Minimizes energy cost for water heating purposes
- Green product - Saves energy
- Protects the hot water pipe system from cracks, scale, swelling and corrosion
- Perfect for Solar heating systems that are backed-up by a Gas heaters
- Can be easily fitted to existing and new plumbing systems

**ADVANTAGES:**

- Special mechanism that ensures no spikes in the home water temperature, at the moment of diversion from one system to another
- No pressure loss even when multiple taps are open
- Large area filters that prevents form clogs as of dirt, scale and fur
- Extremely accurate temperature control mechanism - no temperature spikes
- Meets multiple international standards
- The temperature can be pre-defined to any required temperature

## ThermoGard

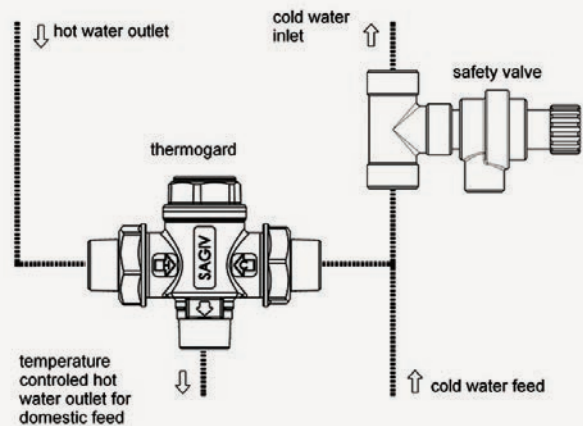

**Sagiv ThermoGard** is a thermostatic mixing valve that restricts the home hot water temperature to a safe temperature, in order to prevent skin burns and scalds as well as protecting the piping system from the hot water temperature – that might reach up to 95°C (200°F) at summer.

Sagiv ThermoGard is fitted between water heaters outlet and the home hot water piping system.

**FEATURES:**

- Prevents hot water burns, mainly with children and elderly people
- Green product - Saves energy and water
- Protects the hot water pipe system from cracks, scale, swelling and corrosion
- Perfect for solar heating systems where temperatures can reach 95°C (200°F)
- Can be easily fitted to existing and new plumbing systems

**ADVANTAGES:**

- No pressure loss even when multiple taps are open
- Large area filters that prevents from clogs as of dirt, scale and fur
- Extremely accurate temperature control mechanism - no temperature spikes
- Meets multiple international standards
- The temperature can be pre-defined to any required temperature

*Water temperature vs. skin exposure:  
3rd degree burn  
(repaired only  
through surgery).*

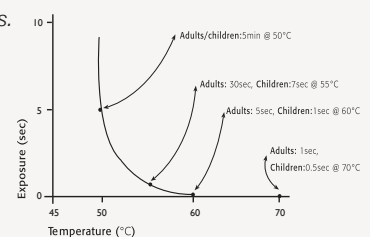



# About Sagiv

## In the heart of the Negev

Located at Mashabei Sadeh, Sagiv is Israel's leading company for the production and export of ball valves, special valves and accessories on demand. These allow full control of water, gas, petrol and oil flow. Our products are integrated within many systems in industry, construction, air conditioning and agriculture.

## International Presence

Our plant exports its products to the most advanced and demanding industrialized nations in the world along with developing areas who are seeking advanced flow control solutions.

## Close to the Customer

Our R&D department works in close liaison with the engineering divisions of our clients. In this way we can give responses in real time to the unique requests that often arise with client projects.

## Excellent Reputation

Sagiv has earned a reputation for high quality, creativity and reliability. As a result of our extensive experience on the industry and our passion to solve the challenges introduced by our customers.

## Financial Strength

Sagiv is equally owned by Kibutz Mashavey Sade and by GaonAgro Industries Ltd. – a subsidiary of Gaon Holdings Ltd, one of Israel's leading investment companies. GaonAgro deals primarily in the water infrastructure industry, water related projects and agriculture.



Kibbutz Mashabei Sade 855 1000 Israel  
Tel. +972-8-6565333 Fax. +972-8-6565340  
sales@sagiv.com



[www.sagiv.com](http://www.sagiv.com)